

# CASE SPECIFICATIONS:

## REFRIGERATION:

LOAD: 4,000 BTU/hr  
 SUCTION TEMP: 30°F  
 SUCTION LINE: 5/8IN ODS  
 LIQUID LINE: 3/8IN ODS

## ELECTRICAL 115V, 60HZ, 1PH

EVAP. FANS: 0.30A  
 LED LIGHTS: 3.6A  
 TOTAL: 1.61A  
 MCA: 15.0A

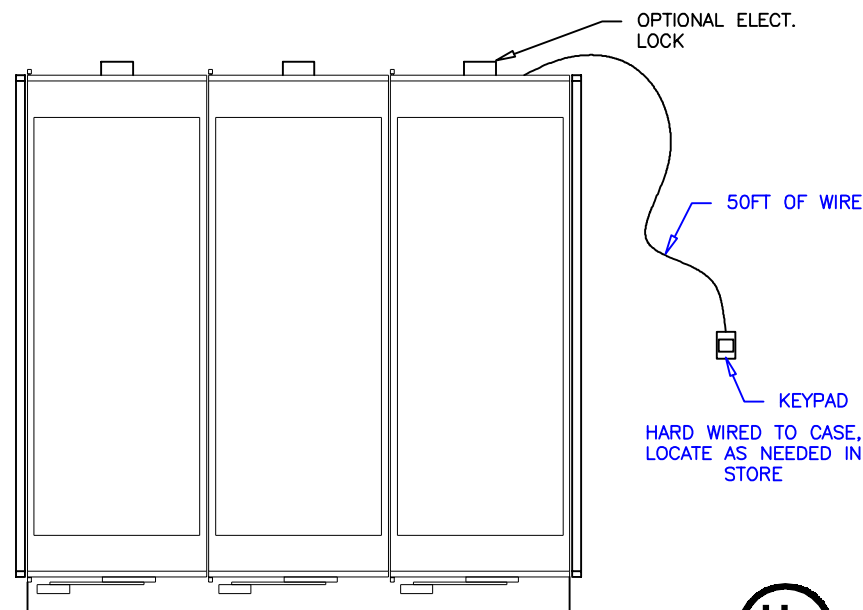
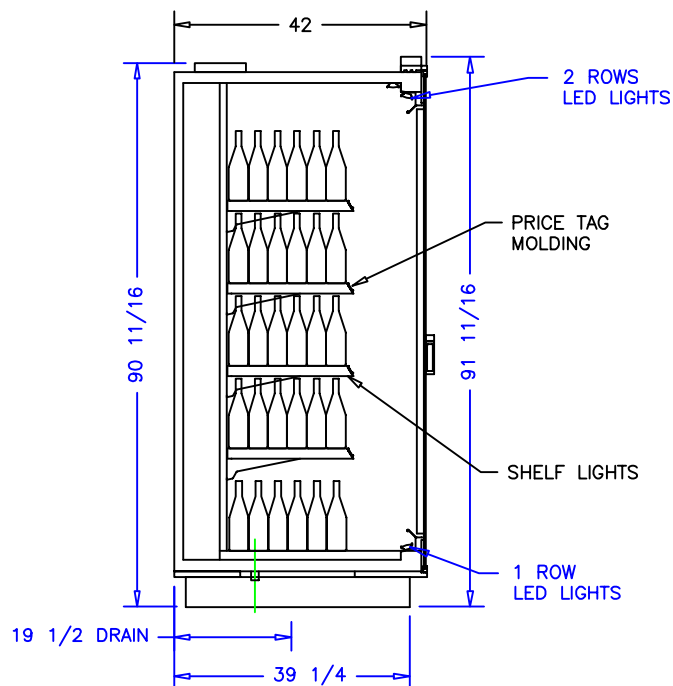
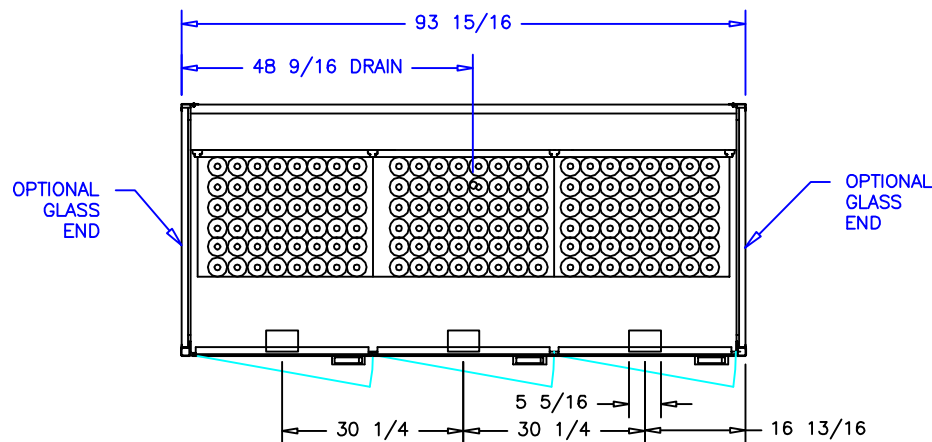

37X1  
 COMMERCIAL REFRIGERATOR  
 LESS CONDENSING UNIT

## NOTES:

1. OPTIONS NOT SHOWN ON DRAWING SHOULD BE LISTED IN WRITTEN PROPOSAL AND LISTED ON PURCHASE ORDER.
2. ELEC. CONNECTION: 115V/230V, 4x4 SUPPLY BOX AS NEEDED.
3. EXPANSION VALVES: SPORLAN "Q" SERIES STANDARD UNLESS OTHERWISE SPECIFIED.
4. DEFROST CONTROL: REMOTE CASES (N/A, DIGITAL CASE CONTROLS AVAILABLE), OPTIONAL CONDENSING UNIT (DIGITAL CASE CONTROLLER).
5. THERMOSTATS & LIQUID LINE SOLENOID VALVES: OPTIONAL.
6. DRAIN: 1 1/2 INCH PVC.
7. SPECIFICATIONS SUBJECT TO CHANGE WITHOUT NOTICE.

AUTHORIZATION (PRINT):

DATE:



börgen systems

SCALE: 1:32

DATE: 2-24-14

DRAWN BY: D HUNT

CHECKED BY:

3 DOOR WINE TALL DP

DATE REV. DIM. INCH

REVISION TOL:

DRAWING NUMBER

P6600