

CASE SPECIFICATIONS:

REFRIGERATION:
 LOAD: 6,070 BTU/hr
 COIL TEMP: 30°F
 SUCTION STUB: 5/8IN ODS
 LIQUID STUB: 3/8IN ODS

ELECTRICAL 115V, 60HZ, 1PH
 EVAP. FANS: 0.6A
 LIGHT BALLASTS: 1.88A
 CONDENSATE PUMP: 1.0A
 CONDENSATE PAN: 3.0A
 TOTAL: 6.48A
 MCA: 15.0A

OPTIONAL ELECTRICAL 208V, 60HZ, 1PH
 3/4 HP COND. UNIT: 6.1A
 TOTAL: 6.1A
 MCA: 8.8A

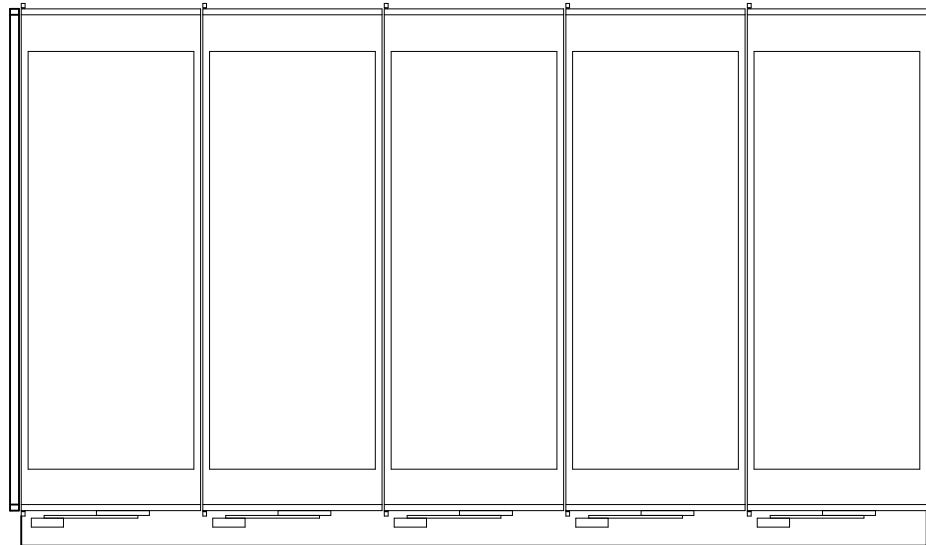
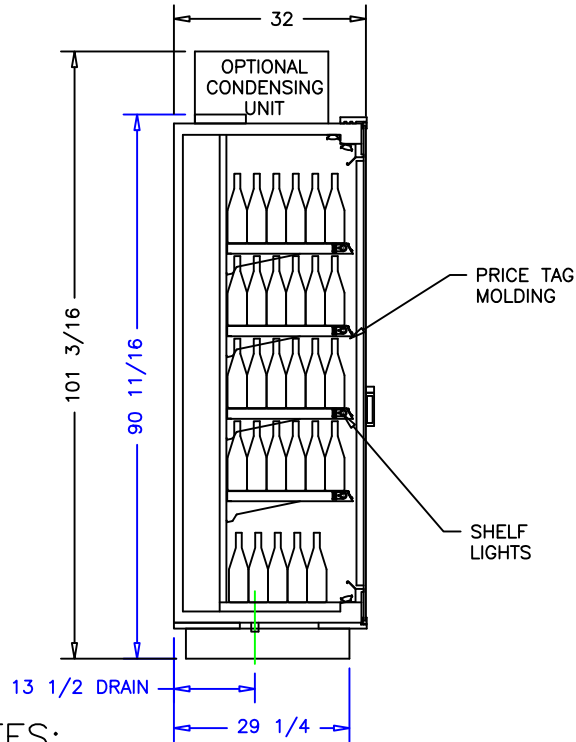
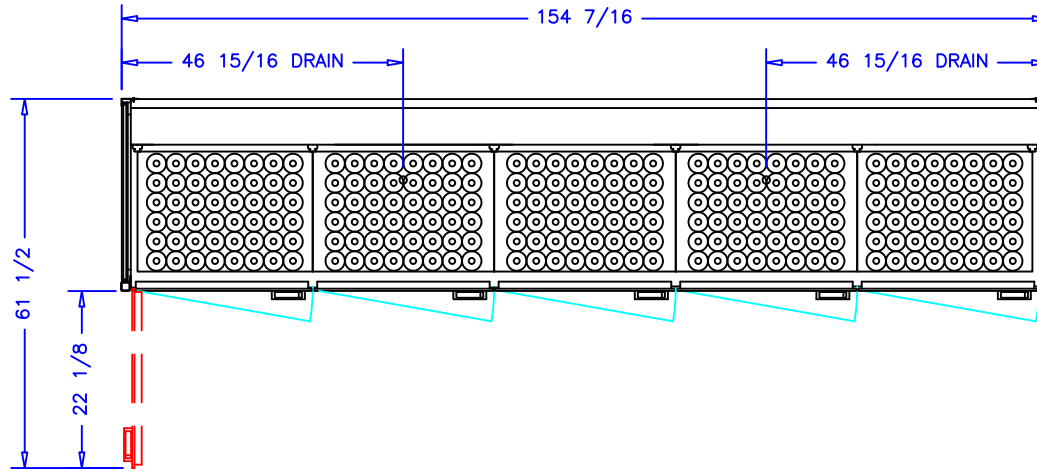

NOTES:

1. OPTIONS NOT SHOWN ON DRAWING SHOULD BE LISTED IN WRITTEN PROPOSAL AND LISTED ON PURCHASE ORDER.
2. ELEC. CONNECTION: 115V/230V, 4x4 SUPPLY BOX AS NEEDED.
3. EXPANSION VALVES: SPORLAN "Q" SERIES STANDARD UNLESS OTHERWISE SPECIFIED.
4. DEFROST CONTROL: REMOTE CASES (N/A, DIGITAL CASE CONTROLLERS AVAILABLE), OPTIONAL CONDENSING UNIT (DIGITAL CASE CONTROLLER).
5. THERMOSTATS & LIQUID LINE SOLENOID VALVES: OPTIONAL.
6. DRAIN: 1 1/2 INCH PVC.
7. SPECIFICATIONS SUBJECT TO CHANGE WITHOUT NOTICE.

AUTHORIZATION (PRINT):	DATE:					SCALE: 1:32	DRAWN BY: D HUNT
		8-17-12	DRH			DATE: 8-10-09	CHECKED BY:
		7-14-11	DRH	5DR WINE TALL			DRAWING NUMBER P6273
		4-28-10	DRH				
		DATE	REV.	DIM:	INCH		
		REVISION		TOL:			