

CROSS SECTION AT WINDOW

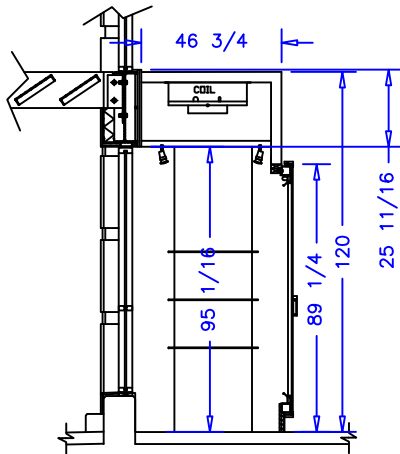

CROSS SECTION AT COLUMN

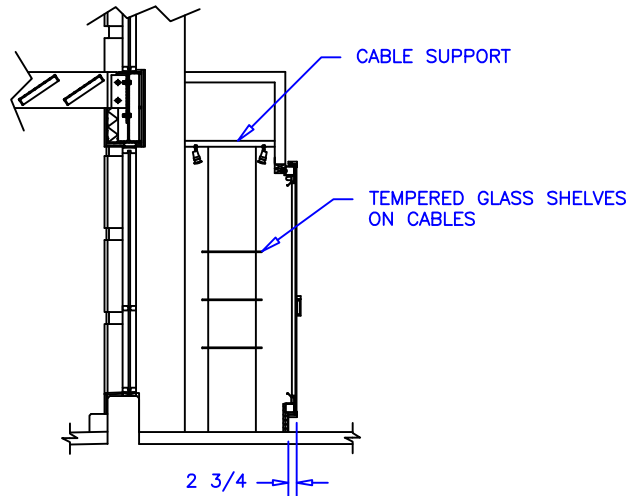

CASE SPECIFICATIONS:

TOP AREA: 172 SQR FT

REFRIGERATION LOAD: 68,500 BTU/hr
 COIL: (3) CTA 58-230
 COIL TEMP: 22° F
 LIQUID: 3/8IN ODS
 SUCTION: 7/8IN ODS

ELECTRICAL 115VAC, 60HZ, 1PH.
 EVAP. FANS: 16.5A
 MERCH. DOOR LIGHTS: 3.76A
 SHELF SUP. LIGHTS: 15.12A
 TOTAL: 35.4A
 MCA: 40.0A

RECOMMENDED ADDITIONAL 115VAC, 15A
 CIRCUIT FOR SUPPLEMENTAL LIGHTING AS
 NEEDED AFTER INSTALLATION.

DISPLAY INFORMATION:
 TEMERED GLASS SHELVES ON CABLES
 ARE HEIGHT ADJUSTABLE.



37X1
 COMMERCIAL REFRIGERATOR
 LESS CONDENSING UNIT

NOTES:

1. OPTIONS NOT SHOWN ON DRAWING SHOULD BE LISTED IN WRITTEN PROPOSAL AND LISTED ON PURCHASE ORDER.
2. ELEC. CONNECTION: 115V/230V, 4x4 SUPPLY BOX AS NEEDED.
3. EXPANSION VALVES: SPORLAN "Q" SERIES STANDARD UNLESS OTHERWISE SPECIFIED.
4. DEFROST CONTROL: REMOTE CASES (N/A, DIGITAL CASE CONTROLLERS AVAILABLE), OPTIONAL CONDENSING UNIT (DIGITAL CASE CONTROLLER).
5. THERMOSTATS & LIQUID LINE SOLENOID VALVES: OPTIONAL.
6. DRAIN: 1 1/2 INCH PVC.
7. SPECIFICATIONS SUBJECT TO CHANGE WITHOUT NOTICE.

AUTHORIZATION (PRINT):		DATE:							
SIGNATURE:		6-12-09	DRH						
		3-2-09	DRH	SCALE: 1:64			DRAWN BY: D HUNT		
		12-9-08	DRH	DATE: 6-17-08			CHECKED BY:		
		11-21-08	DRH					17DR WOD TALL	
		11-20-08	DRH						
		DATE	REV.	DIM:	INCH			DRAWING NUMBER	
		REVISION	TOL:					P5434	



börger systems