

OPEN CASE SPECIFICATIONS:

REFRIGERATION

LOAD: *8,550 BTU/hr*
 SUCTION TEMP: 20° F
 LIQUID LINE: 3/8IN ODS
 SUCTION LINE: 5/8IN ODS

ELECTRICAL 115V, 60HZ, 1PH.
 EVAP. FANS: 0.72A
 LIGHT BALLASTS: 2.4A
 TOTAL: *3.12A*

ELECTRICAL 230V, 60HZ, 1PH.
 1 1/2HP COND. UNIT: 15.9A
 TOTAL: *15.9A*

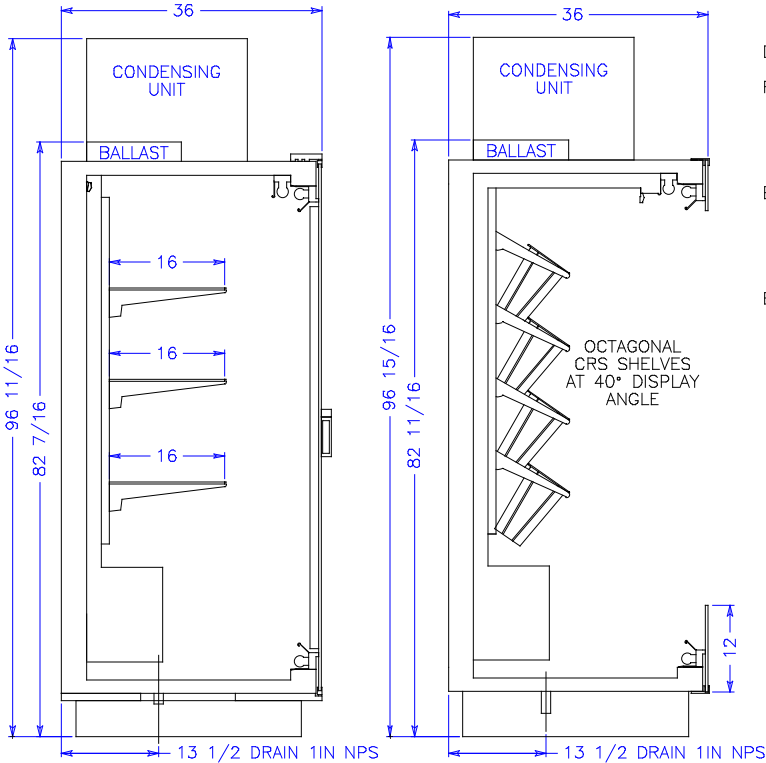
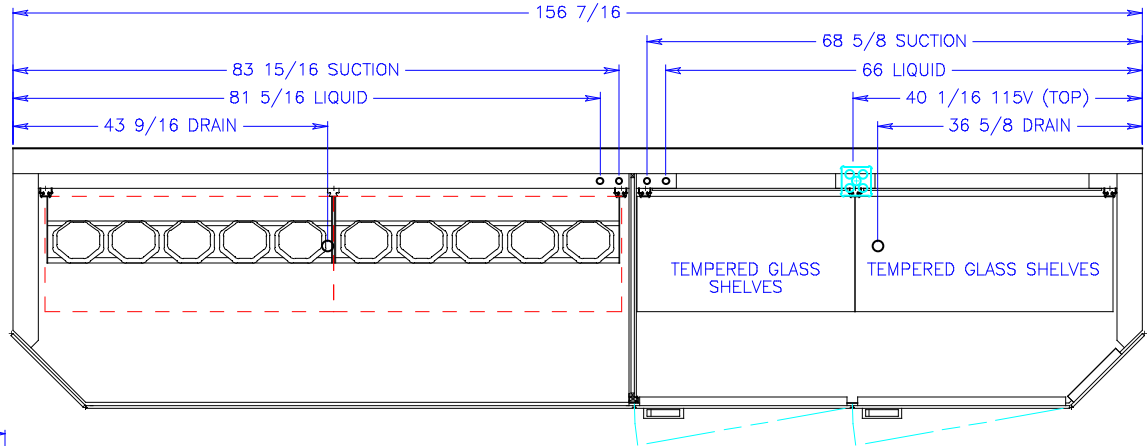

DOORED CASE SPECIFICATIONS:

REFRIGERATION

LOAD: *2,875 BTU/hr*
 SUCTION TEMP: 20° F
 LIQUID LINE: 3/8IN ODS
 SUCTION LINE: 5/8IN ODS

ELECTRICAL 115V, 60HZ, 1PH.
 EVAP. FANS: 0.36A
 LIGHT BALLASTS: 2.4A
 CONDENSATE PUMP: 1.0A
 TOTAL: *3.76A*

ELECTRICAL 230V, 60HZ, 1PH.
 EVAP. PAN: 6.5A
 1/2HP COND. UNIT: 7.0A
 TOTAL: *13.5A*

NOTE:

GLASS HEIGHT OF OPEN SECTION HAS BEEN REDUCED PER CUSTOMER REQUEST.

THIS WILL INCREASE ENERGY USAGE AND REDUCE THE COOLING EFFECTIVENESS.

NOTES:

1. OPTIONS NOT SHOWN ON DRAWING SHOULD BE STATED IN WRITTEN PROPOSAL AND LISTED ON PURCHASE ORDER.
2. ELEC. CONNECTION: 115V/230V, 4X4 SUPPLY BOX AS NEEDED.
3. EXPANSION VALVES: SPORLAN "Q" SERIES STANDARD UNLESS OTHERWISE SPECIFIED.
4. DEFROST CONTROL: REMOTE CASES (N/A, DIGITAL CASE CONTROLLERS AVAILABLE), OPTIONAL CONDENSING UNIT (DIGITAL CASE CONTROLLER).
5. THERMOSTATS & LIQUID LINE SOLENOID VALVES: OPTIONAL.
6. DRAIN: 1 INCH NATIONAL PIPE STRAIGHT THREAD.
7. SPECIFICATIONS SUBJECT TO CHANGE WITHOUT NOTICE.

		börgeren systems	
	SCALE: 1:16		DRAWN BY: J. MAUK
	DATE: 4-23-98		CHECKED BY:
5-24-99	DRH	2DR 2 BAY OPEN 75 LEFT	
12-29-98	DRH		
DATE:	REV.	DIM: INCHES	DRAWING NUMBER
REVISION		TOL: ±1/4	P2733B